

Exploded view of prepared recesses and install

VS Euro Locking Flush Pull

Internal view

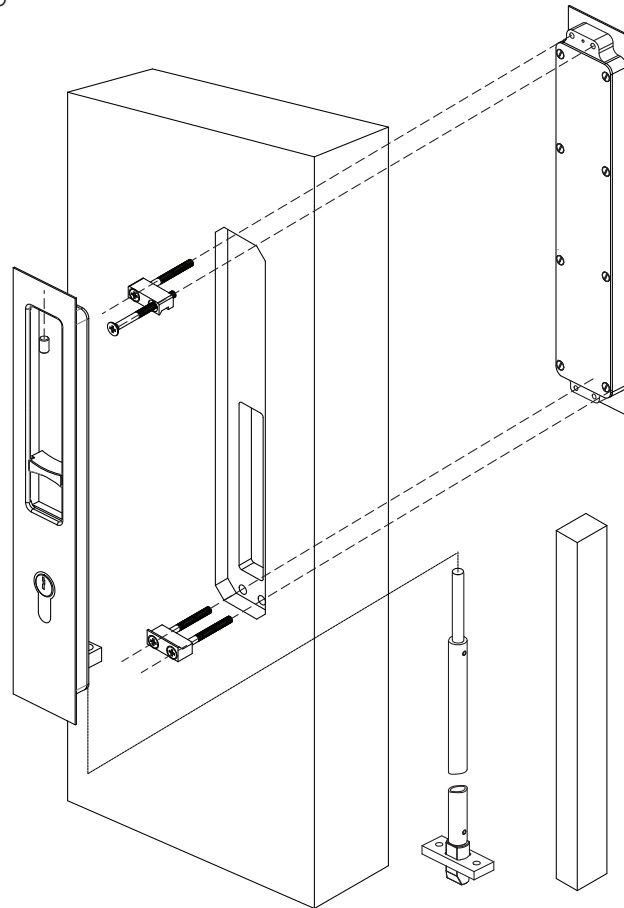

For painted doors the rod recess channel is machined into the door surface. Once the rod channel is created a timber insert must be packed into the cavity (leaving the rod channel clear) and then the door must be refinished to high level for painting.

External view

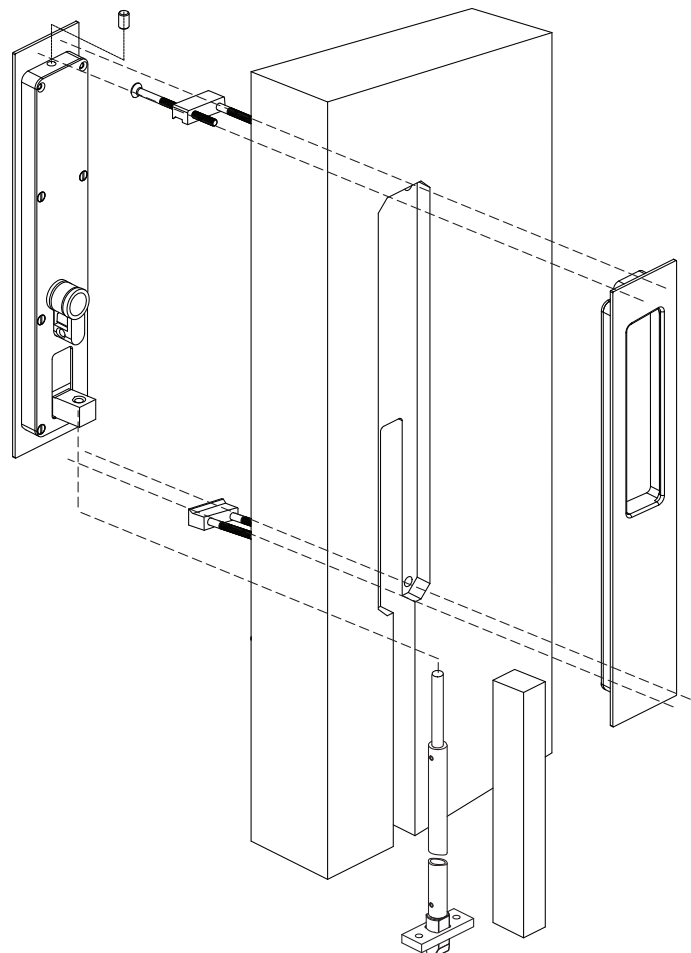

Product information

Products are typically positioned with the product centreline at 1000mm from the floor.

The locking rod can be installed dropping to the floor or rising into the head of the door. Consider the track system of the sliding when specifying these product.

Extensions are manufactured to the required length and are manufactured from M8 SS rod or in aluminium tube for extended lengths over 1000mm.

Timber door products are supplied with a guide plate positioned where the rod tip exits the door.

Flat, water proof strikes and dust sockets are sold separately against the particular requirements of the doors

Bolt tip dimensions

