

Flush Bolt - Flat Bolt

This product has been designed to provide contemporary flush locking systems for conventional, bifold and sliding doors.

- Solid brass construction
- 20mm throw
- 10.5mm & 5.5mm offsets
- Non locking & locking options

Offset

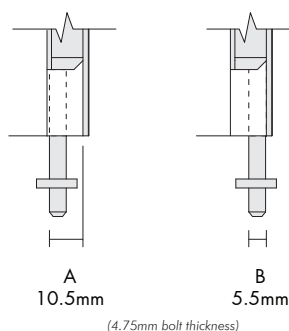

Top Profile Options

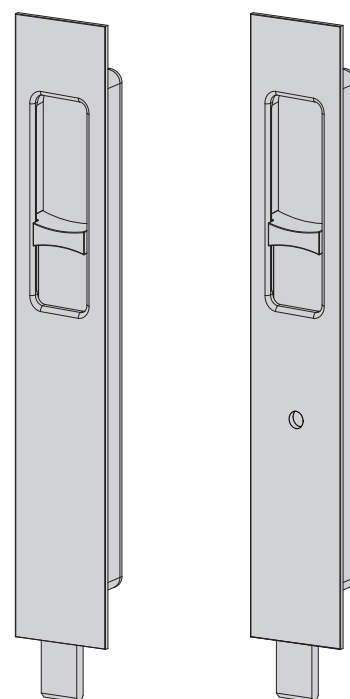
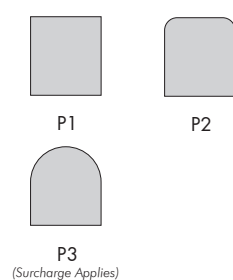

Ordering

- 1 Select length/width and throw e.g 2011 - 3
- 2 Select offset on order form A - 10.5 / B - 5.5
- 3 Specify top profile shape on order form P1 - P3

Length - Throw

200 - 20T

Non Locking

Width

38	2011 - 3
44	2011 - 4

200 - 20T

Locking

Width

38	2021 - 3
44	2021 - 4

220 - 40T

Non Locking

Width

38	2111 - 3
44	2111 - 4

240 - 40T

Locking

Width

38	2121 - 3
44	2121 - 4

Strike & Guide Options

Visit the **Bolt Strikes & Guides** section for available options

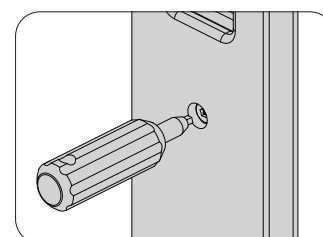

Locking version includes
2799 locking key