

## Flush Pull Bolts - Key Locking

This product has been designed to provide contemporary flush locking system for conventional, bifold and sliding doors without the requirement of a lock but can be locked or unlocked with a C4 profile key from the inside.

- Designed & manufactured in New Zealand
- 5 pin Cylinder
- Minimum door thickness 44mm
- 20mm throw
- Adjustable offset block - 16.5 - 30mm
- Rod kit included up to 1.5m

### Placement & Offset

Adjustable Offset - 16.5 - 30mm

#### Placement - D

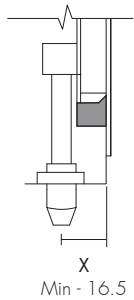

#### Product Position

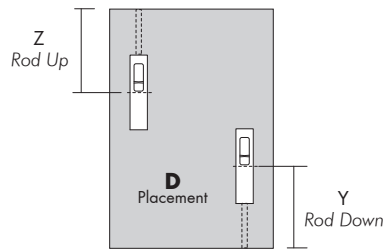

Y / Z dimension determines the rod length supplied, based on placement of center line of product.

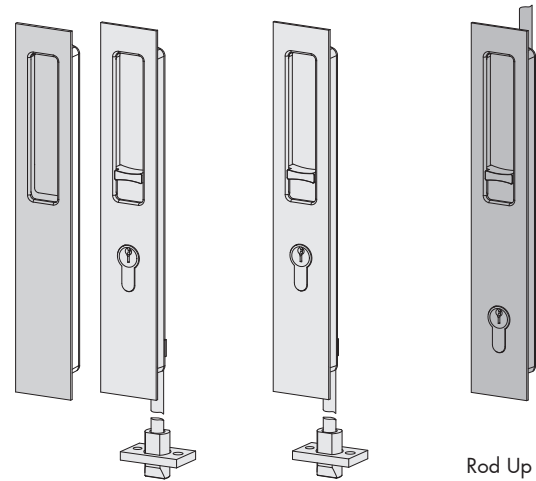

Cylinder Inside 'CI'

Inside Only "IO"

Rod Up

The cylinder sits lower in the rod down version to clear the bolt

### Ordering

- 1 Select length/width and throw e.g 2631 - CI - 3
- 2 Specify profile shape on order form P1 - P3. Code becomes 2631 - CI - (P1)
- 3 Select placement D.
- 4 Specify Y or Z product position on order form e.g 300mm

#### Profile Options

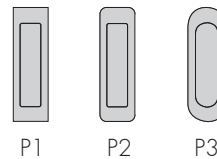

#### Cylinder Inside

		Width	38	44	50
Length & Rod	300 Rod Down (Y)		2631 - CI - 3	2631 - CI - 4	2631 - CI - 5
	300 Rod Up (Z)		2636 - CI - 3	2636 - CI - 4	2636 - CI - 5

#### Inside Only

		Width	38	44	50
Length & Rod	300 Rod Down (Y)		2631 - IO - 3	2631 - IO - 4	2631 - IO - 5
	300 Rod Up (Z)		2636 - IO - 3	2636 - IO - 4	2636 - IO - 5

## Strike & Guide Options

Visit the **Bolt Strikes & Guides** section for available options