

## Mortising Equipment - Jigs

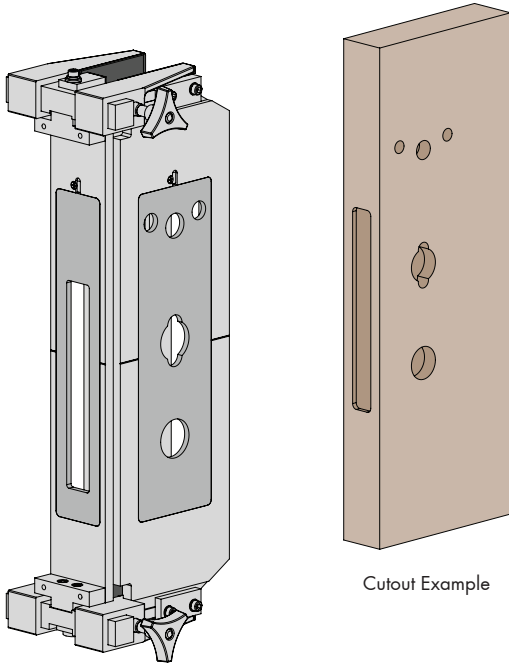

Cutout Example

### 3 Sided Routing Jigs

3 Sided Routing Jigs are designed for quick and accurate routing for the installation of Mortise Locks (lock faceplate, cylinder and lever) as well as Sliding Door products, including Locks and Flush Pulls.

Interchangeable templates make multi-step mortising easy.

Adjustable backset from **35mm - 80mm**.

Door clamps are self-centering, have protective face pads and are designed with toe in to provide secure clamping on the door.

Suits door thickness of **35mm - 90mm** (1 3/8" - 3 1/2").

### 3 Sided Routing Jig - 6013 Vingcard Version

#### Templates

Faceplate - 6013T - 60 x 330

Side Marking - 6013TS - 100 x 330

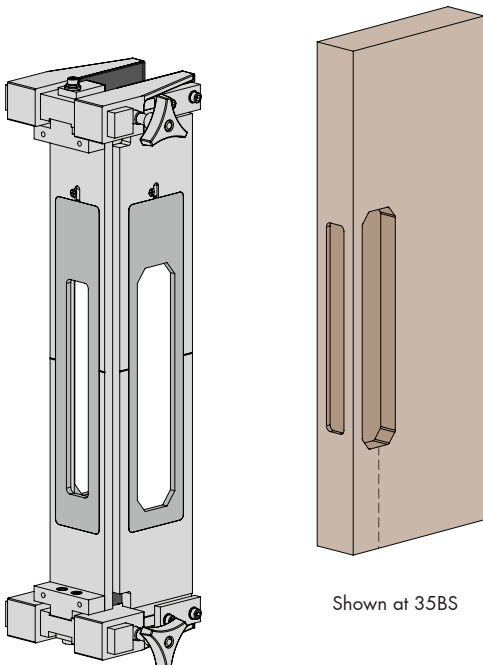

Shown at 35BS

Fitted with templates for Chant VS Lock & Flush Pulls

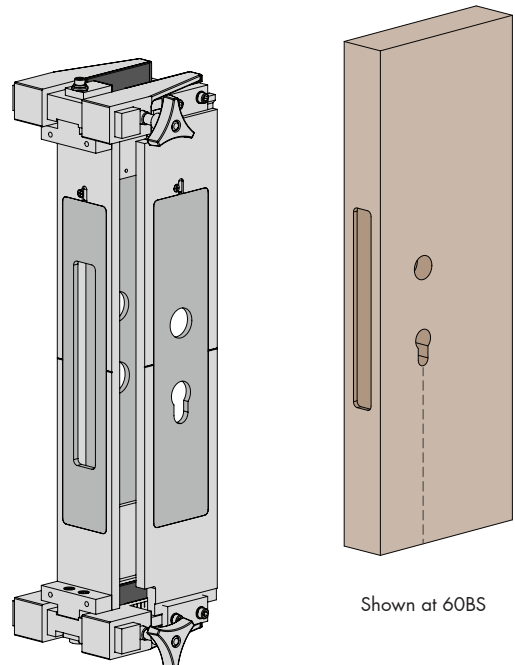

Shown at 60BS

Fitted with templates for Chant Mortise Lock

### 3 Sided Routing Jig - 6014 Standard

#### Templates

Faceplate - 6014T - 60 x 330

Side Marking - 6014TS - 75 x 330

## Mortising Equipment - Jigs

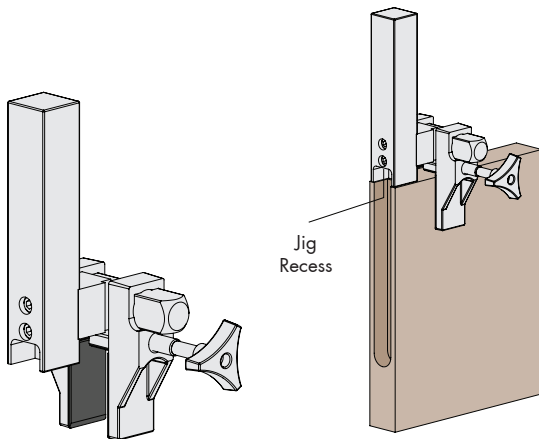

### Door Extension Jig - 6011

This jig is used to allow for the attaching of a 6014 3 Sided Jig past the end of the door to do a cutout like the example above. The router cutter runs out into the jig recess.

i.e Chant square bolts.

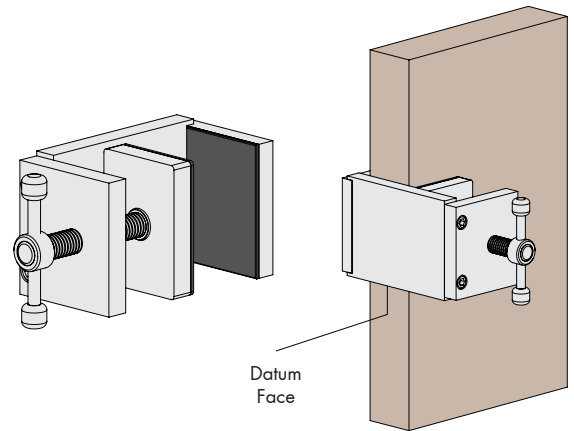

### Vertical Locating Clamps - 6040

Used for allowing the easy location of jigs by fitting to the door first at the correct height with allowance for the jig.

The datum face is used to locate the lock mortising machine and 3 sided routing jigs.

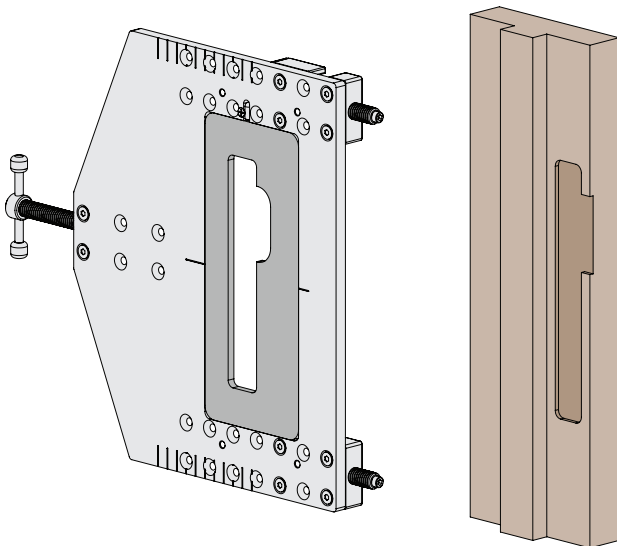

### Strike Plate Jig - 6041

The Strike Plate Jig clamps to the door jamb for the routing of strike plates and strike boxes.

Interchangeable templates that make it possible to rout the strike box while the jig is still set on the door jamb.

Clamps are designed for door jambs up to 160mm thick, or the planted stop.

#### Template

6041T - 100 x 240

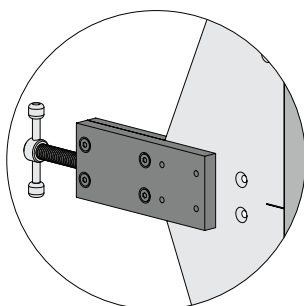

### Jamb Extension Bar - 6042

To suit 6041 strike plate jig

Extension bar is required for wider door frames over 160mm.

## Mortising Equipment - Jigs

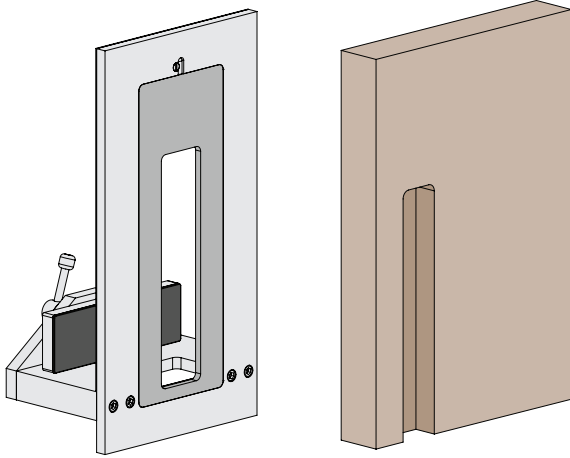

### Sliding Flush Bolt Jig - 6044

i.e Chant flush bolts

#### Template

6044T - 100 x 280

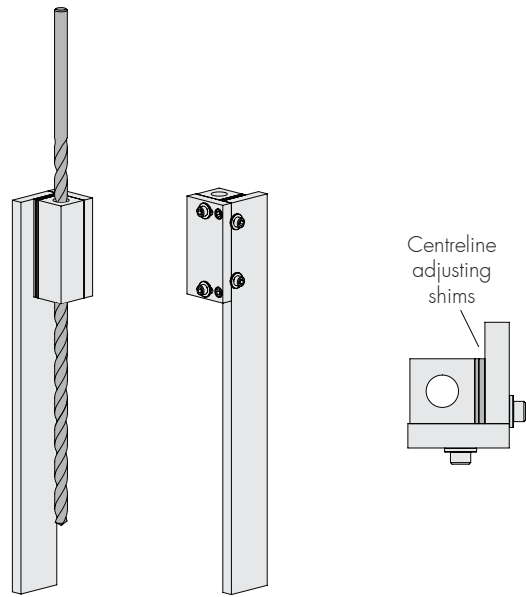

### Drill Jig - 6046

Sliding bolt rod drill jig.

#### Available Drills

6046-1 - 12.7 x 600mm Drill

6046-2 - 12.7 x 1000mm Drill